

SIGNING AND STRIPING NOTE REQUIREMENTS:

1. ALL PAVEMENT MARKINGS SHALL CONFORM TO THE ARIZONA DEPARTMENT OF TRANSPORTATION SPECIFICATIONS AND THE MANUAL OF UNIFORM TRAFFIC CONTROL DEVICES, LATEST EDITIONS.

2. THE CONTRACTOR SHALL SPOT MARK THE ENTIRE PROJECT BEFORE APPLYING ANY PAINT. WHEN THE SPOTTING IS COMPLETE THE CONTRACTOR SHALL CONTACT THE PINAL COUNTY INSPECTION SECTION TO MAKE ARRANGEMENTS FOR INSPECTION PRIOR TO APPLYING ANY PAINT (MINIMUM 5 WORKING DAYS ADVANCE).

3. ANY PAVEMENT MARKINGS APPLIED PRIOR TO FIELD INSPECTION BY THE PINAL COUNTY INSPECTION SECTION SHALL BE REMOVED AND RE-STRIPED AT THE EXPENSE OF THE CONTRACTOR.

4. IT IS THE CONTRACTOR'S RESPONSIBILITY TO ENSURE THAT THE FINAL SURFACE COURSE IS PLACED SO THAT THE STRIPPING IS OFFSET 1 FOOT CLEAR OF THE CONSTRUCTION JOINT, UNLESS OTHERWISE DIRECTED BY THE ENGINEER.

5. THE DIMENSIONS SHOWN FOR THE PAVEMENT STRIPING ARE TO THE CENTER OF THE STRIPING OR, IN THE CASE OF DOUBLE STRIPING, TO THE CENTER OF THE DOUBLE STRIPE.

6. THE FINAL STRIPING SHALL BE 60 MIL (0.060 INCH) THICK HOT-SPRAYED THERMOPLASTIC REFLECTORIZED STRIPING.

7. THE PAVEMENT ARROW AND "ONLY" LEGEND SHALL BE WHITE 90 MIL (0.090 INCH) THICK ALKYD EXTRUDED THERMOPLASTIC REFLECTORIZED MARKINGS.

8. THE CONTRACTOR SHALL CLEAN THE ROADWAY SURFACE TO THE SATISFACTION OF THE INSPECTOR, BY SWEEPING AND AIR-JET BLOWING, IMMEDIATELY PRIOR TO THE PLACEMENT OF ALL PAVEMENT MARKINGS. THE ROADWAY SURFACE SHALL BE DRY AND THE AIR AND PAVEMENT TEMPERATURES SHALL NOT BE LESS THAN 50 DEGREES F FOR THE PLACEMENT OF THE THERMOPLASTIC MARKINGS.

9. ALL RAISED PAVEMENT MARKERS SHALL HAVE AN ABRASION RESISTANT COATING ON THE FACE OF THE PRISMATIC REFLECTORS AND SHALL CONFORM TO THE DETAILS OF STD. DWG. M-19. THEY SHALL BE INSTALLED WITH A BITUMINOUS ADHESIVE WHICH IS ON THE ADOT APPROVED PRODUCT LIST.

10. WHERE RAISED PAVEMENTS MARKERS ARE PLACED ALONG SOLID STRIPING, THE NEAREST EDGE OF EACH MARKER SHALL BE OFFSET 2 INCHES FROM THE NEAREST EDGE OF THE STRIPING.

11. ALL SIGNS MUST BE IN COMPLIANCE WITH THE MUTCD AND THE ADOT SIGNING AND MARKING STANDARD DRAWINGS.

12. THE BOTTOM OF EACH SIGN SHALL BE AT LEAST 7 FEET ABOVE THE NEAREST EDGE OF PAVEMENT AND AT LEAST 7 FEET ABOVE THE GROUND UNDER THE SIGN.

13. THE CONTRACTOR SHALL INSTALL THE SIGNS SO THE NEAREST EDGE OR CORNER OF EACH SIGN IS OFFSET 2 FEET BEHIND THE BACK OF THE SIDEWALK.

14. ALL SIGNS SHALL BE FABRICATED OF FLAT SHEET ALUMINUM WITH DIRECT APPLIED COPY OR SILK-SCREENED LEGEND.

15. ALL WARNING, REGULATORY AND STREET NAME SIGNS ARE TO BE INSTALLED ON 2" SQUARE TUBING PER ADOT SIGNING & MARKING STANDARDS WITH POST FOUNDATIONS PER (DETAIL S-1, SHEET 2 OF 4).

16. ALL SIGNS MUST BE MANUFACTURED OF "ASTM D-4956-01A- PROPOSED TYPE XI SHEETING" (3M 4000 DG SERIES OR EQUIVALENT) WHICH WILL BE ATTACHED TO THE STANDARD SIGNAGE ALUMINUM PLATES. SIGN IMAGING SHALL BE IN COMPLIANCE WITH HE REFLECTIVE SHEETING MANUFACTURES MATCHED COMPONENT SYSTEM. SIGN IMAGING SHALL CONSIST OF AN ACRYLIC BASED ELECTRONIC CUTTABLE FILM (3M 1170 SERIES OR EQUIVALENT) OR SILK SCREENED (DEPENDING ON THE QUANTITY OF SIGNAGE) WITH STANDARD HIGHWAY COLORS. IN ADDITION, IF CALLED OUT ON PLANS, TO CREATE A GRAFTIT-PROTECTIVE COATING, A PREMIUM PROTECTIVE OVERLAY FILM (3M 1160 OR EQUIVALENT) SHALL BE USED WHICH IS DESIGNATED TO COMPLY WITH THE UNDERLYING REFLECTIVE SHEETING MATCH COMPONENT SYSTEM.

OFFSITE IMPROVEMENT PLANS

FOR

COMBS TRADITIONAL ACADEMY

37327 N. GANTZEL RD.
SAN TAN VALLEY, AZ 85140

FOR

J.O. COMBS UNIFIED SCHOOL DISTRICT

301 E. COMBS RD.
SAN TAN VALLEY, AZ 85140
PHONE: (480) 987-5300

PINAL COUNTY, ARIZONA

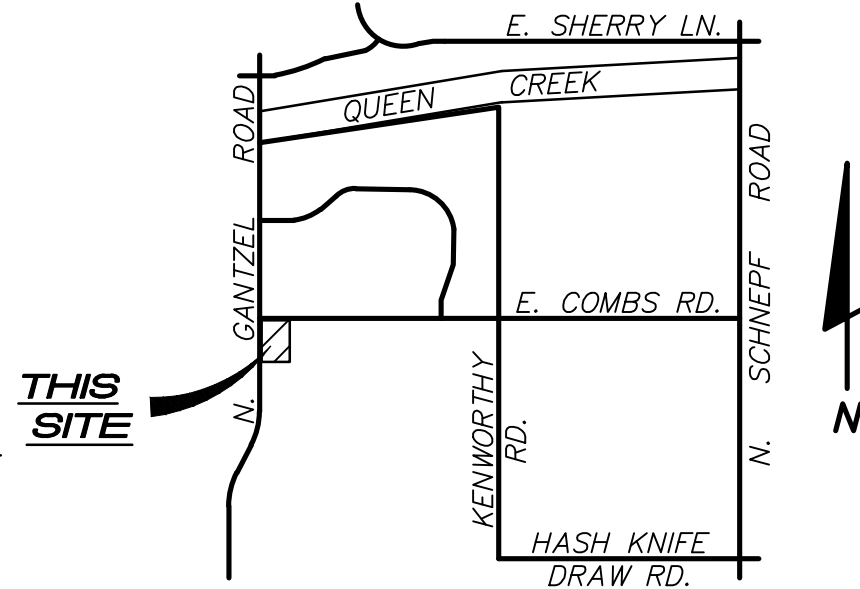

VICINITY MAP
NOT TO SCALE

RETENTION CALCULATIONS:

THERE IS A SMALL DRAINAGE AREA THAT DRAINED INTO THE EXISTING RETENTION BASIN LOCATED BETWEEN THE TWO EXISTING SCHOOL DRIVEWAYS ALONG NORTH GANTZEL ROAD. DRAINAGE ENTERED INTO THIS RETENTION AREA VIA AN EXISTING CURB OPENING. A NEW CONCRETE SIDEWALK SCUPPER WILL BE INSTALLED AND THE EXISTING BASIN WILL BE REGRADED AS NEEDED FOR THE NEW IMPROVEMENTS TO HOLD THE 100-YEAR, 2-HOUR RETENTION REQUIREMENTS.

VOLUME REQUIRED:

AREA = 24,872 SF

VOLUME REQUIRED (100 YEAR-2 HOUR STORM)

WEIGHTED RUNOFF COEFFICIENT (C FACTOR)

AREA (BLDG., CONC., PAVE.)	(C=0.95) =	14,850 SF
AREA (DECOMPOSED GRANITE)	(C=0.50) =	10,022 SF
AREA (TOTAL)		= 24,872 SF

$$C = \frac{10,022(0.50) + 14,850(0.95)}{24,872} = 0.77$$

$C_w = 0.77$
 $P = 2.76$ INCHES, FROM COUNTY DESIGN MANUAL USED
APACHE JUNCTION VALUE
 $V_r = \frac{0.77(2.76)(24,872)}{12} = 4,405$ CF

VOLUME PROVIDED:

BASIN A-1

BOTT. AREA	=	5,194 SF
H.W.L. AREA	=	7,038 SF
DEPTH	=	0.90 FT
VP	=	1/2 (5,194+7,038)(0.90)
	=	5,504 CF > 4,405 CF

DISSIPATION:

THE RETENTION BASIN IS LESS THAN A FOOT DEEP AND SHOULD PERCOLATE WITHIN 36 HOURS.

ENGINEER:

HESS-ROUNTREE, INC.
9831 SOUTH 51ST STREET, SUITE C110
PHOENIX AZ, 85044
PHONE: (480) 496-0244
FAX: (480) 496-0094
CONTACT: PERCY MYRON, JR., PE
EMAIL: PERCYM@HESSROUNTREE.COM

OWNER/DEVELOPER:

J.O. COMBS UNIFIED SCHOOL DISTRICT
301 E. COMBS RD.
SAN TAN VALLEY, AZ 85140
PHONE: (480) 987-5300

SHEET INDEX

OP-1 COVER SHEET
OP-2 OFFSITE PAVING PLAN

APPROVED BY:

PINAL COUNTY ENGINEER
PINAL COUNTY, DEPARTMENT OF PUBLIC WORK

APPROVAL EXPIRES:

ESTIMATED QUANTITIES:

DESCRIPTION:	ESTIMATED QUANTITY
1. SAWCUT AND REMOVE EXISTING CONCRETE SIDEWALK	225 SF
2. SAWCUT AND REMOVE EXISTING VERTICAL CURB AND GUTTER	435 LF
3. SAWCUT AND REMOVE EXISTING CONCRETE APRON	6,450 SF
4. CONCRETE SIDEWALK	4,487 SF
5. 4-FOOT WIDE CONCRETE SIDEWALK SCUPPER	1 EA
6. CONCRETE VERTICAL GUTTER AND APRON	2,664 SF
7. CONCRETE VERTICAL CURB AND GUTTER	431 LF
8. SAWCUT, REMOVE AND REPLACE AREERIAL ROAD A.C. PAVEMENT (6" A.C. OVER 10" A.B.C. OVER COMPCATED SUBGRADE).	70 SY
9. SAWCUT, REMOVE AND REPLACE A.C. PAVEMENT (3" A.C. OVER 8" A.B.C. OVER COMPACTED SUBGRADE	16 SY
10. CONCRETE SIDEWALK RAMP	6 EA

NOTE:

ESTIMATED QUANTITIES ARE FOR PERMIT PURPOSES ONLY AND SHOULD BE VERIFIED BY THE CONTRACTOR.

BASIS OF BEARING

THE BEARING OF NORTH 89 DEGREES 31 MINUTES 24 SECONDS EAST AS SHOWN ON THE NORTH LINE OF THE NORTHWEST QUARTER OF SECTION 32, TOWNSHIP 2 SOUTH, RANGE 8 EAST OF THE GILA AND SALT RIVER MERIDIAN.

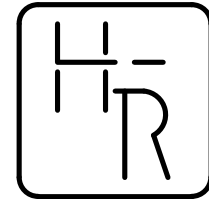

HESS - ROUNTREE, INC.
CONSULTING ENGINEERS & LAND SURVEYORS
9831 SOUTH 51ST STREET, SUITE C110
PHOENIX, ARIZONA 85044 (480)496-0244

DES. **DRO** DRN. **ANM** CKD **DRO** JOB NO. **2003-02**

DESIGN CIVIL ENGINEER'S
NOTES TO CONTRACTOR:

1. NOTHING CONTAINED IN THE CONTRACT DOCUMENTS SHALL CREATE, NOR SHALL BE CONSTRUED TO CREATE, ANY CONTRACTUAL RELATIONSHIP BETWEEN THE DESIGN CIVIL ENGINEER AND THE CONTRACTOR OR ANY SUBCONTRACTOR.

2. THE DESIGN CIVIL ENGINEER WILL NOT BE RESPONSIBLE FOR CONSTRUCTION MEANS, METHODS, TECHNIQUES, SEQUENCES OR PROCEDURES OR FOR SAFETY PRECAUTIONS OR PROGRAMS UTILIZED IN CONNECTION WITH THE WORK. THESE ARE SOLELY THE CONTRACTOR'S RESPONSIBILITY. THE DESIGN CIVIL ENGINEER WILL NOT BE RESPONSIBLE FOR THE CONTRACTOR'S FAILURE TO CARRY OUT THE WORK IN ACCORDANCE WITH THE CONTRACT DOCUMENTS.

3. THE CONTRACTOR SHALL PROVIDE ADEQUATE MEANS OF CLEANING TRUCKS AND/OR OTHER EQUIPMENT OF MUD PRIOR TO ENTERING PUBLIC STREETS, AND IT IS THE CONTRACTOR'S RESPONSIBILITY TO CLEAN STREETS, ALLAY DUST, AND TO TAKE WHATEVER MEASURES ARE NECESSARY TO INSURE THAT ALL ROADWAYS AND ON SITE PARKING LOTS/FIRE LANES ARE MAINTAINED IN A CLEAN, MUD AND DUST-FREE CONDITION AT ALL TIMES.

4. IT SHALL BE THE CONTRACTOR'S RESPONSIBILITY TO CONTACT THE BLUE STAKE CENTER TWO WORKING DAYS PRIOR TO ANY EXCAVATION. THE UNDERGROUND UTILITY LOCATIONS AS SHOWN HEREON ARE BASED ON THE BEST INFORMATION AVAILABLE FROM UTILITY RECORDS AND OTHER DATA AS SUPPLIED TO THIS DESIGN CIVIL ENGINEER. THERE MAY BE OTHER UNDERGROUND UTILITY LINES, SERVICE LINES AND STRUCTURES PRESENT IN THE SUBJECT AREA. CONTRACTOR SHALL INCLUDE IN HIS BID THE COST OF HIRING AN UNDERGROUND UTILITY LOCATING SERVICE FOR THE PURPOSE OF LOCATING ALL UNDERGROUND UTILITIES. CONTRACTOR WILL COORDINATE WITH THE OWNER AND ARCHITECT TO DETERMINE WHETHER SAID UTILITIES ARE TO BE ABANDONED OR PROTECTED FROM DAMAGE.

5. THE DESIGN CIVIL ENGINEER MAKES NO REPRESENTATION OR GUARANTEE REGARDING THE EARTHWORK QUANTITIES OR THAT THE EARTHWORK FOR THIS PROJECT WILL BALANCE DUE TO THE VARYING FIELD CONDITIONS, CHANGING, SOIL TYPES, ALLOWABLE CONSTRUCTION TOLERANCES AND CONSTRUCTION METHODS. PRIOR TO BIDDING THE WORK, THE CONTRACTOR SHALL THOROUGHLY SATISFY HIMSELF AS TO THE ACTUAL CONDITIONS, EARTHWORK QUANTITIES AND REQUIREMENTS OF THE WORK AND EXCESS OR DEFICIENCY THEREIN, ACTUAL OR RELATIVE.

6. THE CONTRACTOR SHALL ADJUST ALL EXISTING AND NEW CLEANOUTS, WATER VALVE BOXES, MANHOLES, GAS VALVE BOXES, IRRIGATION BOXES, ETC. IN THE CONSTRUCTION AREA TO FINISH GRADE PER THE APPLICABLE MAG STANDARD DETAIL. ALL VALVE BOXES, MANHOLES, ETC. IN CONCRETE PAVEMENT AREAS SHALL BE ISOLATED FROM THE CONCRETE PAVEMENT WITH EXPANSION JOINTS.

7. ALL NEW UNDERGROUND FACILITIES/UTILITIES SHALL BE INSTALLED WITH A DETECTABLE UNDERGROUND LOCATION DEVICE. INSTALL A #18 INSULATED TRACER WIRE SECURELY ATTACHED TO EACH UTILITY AT 8'-FEET ON CENTER. 12" OF TRACER WIRE SHALL BE ACCESSIBLE ABOVE GRADE AT THE TERMINATION AND SHALL BE SECURELY ATTACHED AT THAT POINT. THE CONTRACTOR SHALL INCLUDE ALL COSTS ASSOCIATED WITH THIS REQUIREMENT IN THEIR BID.

8. THE CONTRACTOR SHALL MAKE NO CLAIMS AGAINST THE OWNER OR THE DESIGN CIVIL ENGINEER REGARDING ALLEGED INACCURACY OF CONSTRUCTION STAKES SET BY THE DESIGN CIVIL ENGINEER UNLESS ALL SURVEY STAKES SET BY THE DESIGN CIVIL ENGINEER ARE MAINTAINED INTACT AND CANNOT BE VERIFIED AS TO THEIR ORIGIN. ANY REMEDIAL WORK REQUIRED TO CORRECT ANY ITEM OF IMPROPER CONSTRUCTION WORK IN THIS DEVELOPMENT SHALL BE PERFORMED AT THE SOLE EXPENSE OF THE RESPONSIBLE CONTRACTOR OR SUBCONTRACTOR.

9. ALL NEW PRIVATE UNDERGROUND UTILITIES (WATER LINES 3" AND LARGER, SEWER LINES, FIRE LINES AND STORM DRAIN LINES SHALL BE BEDDED WITH A.B.C., PER MAG SECTION 702, FROM 4" (MIN.) BELOW THE BOTTOM OF THE PIPE TO 12" (MIN.) ABOVE THE TOP OF THE PIPE.

BENCHMARK

TOP OF 1/2" REBAR WITH 2" MARICOPA COUNTY ALUMINUM CAP IN DITCH ON EAST SIDE OF MERIDIAN ROAD AT THE NORTHWEST CORNER OF COUNTY THUNDER PROPERTY. MARICOPA COUNTY CORNER #21077-IM.

ELEVATION = 1386.144 (NAVD 88 DATUM)

AS-BUILT CERTIFICATION:

I HEREBY CERTIFY THAT THE "RECORD DRAWING" MEASUREMENTS AS SHOWN HEREONWERE MADE UNDER MY SUPERVISION OR AS NOTED AND ARE CORRECT TO THE BEST OF MY KNOWLEDGE AND BELIEF.

REGISTERED ENGINEER/LAND SURVEYOR DATE

REGISTRATION NUMBER

COVER SHEET

J.O. COMBS UNIFIED SCHOOL DISTRICT			
IMPROVEMENT PLANS FOR COMBS TRADITIONAL ACADEMY			
DRAWING STATUS	SHEET	OF	OP-1
CONSTRUCTION	1	2	
DOCUMENTS			
DATE: 06-05-20			



THESE PLANS HAVE BEEN SUBMITTED TO THE FOLLOWING UTILITY COMPANIES AND THE WORK CONTAINED IN THESE PLANS HAS BEEN APPROVED BY THESE COMPANIES WITHIN THEIR AREA OF INTEREST. THE SIZE AND LOCATIONS, AS SHOWN OF THE GAS, TELEPHONE AND POWER LINES, AND CONNECTIONS AGREE WITH THE INFORMATION CONTAINED IN THE UTILITY COMPANY'S RECORDS. WHERE THE WORK TO BE DONE CONFLICTS WITH ANY OF THESE UTILITIES. THE CONFLICTS SHALL BE RESOLVED AS SPECIFIED IN THE SPECIAL PROVISIONS AND/OR AS OTHERWISE NOTED ON THESE PLANS. CONFLICTS ARISING DURING THE COURSE OF CONSTRUCTION FROM UNFORESEEN CIRCUMSTANCES SHALL BE REPORTED TO THE INTERESTED UTILITY COMPANY AND BE RESOLVED BY THEM AND THE DESIGN ENGINEER.

CITY OF MESA UTILITIES	CHRIS MEHAN CO. REPRESENTATIVE CONTACTED	.	DATE SUBMITTED
COX COMMUNICATIONS	USIC DISPATCH CENTER CO. REPRESENTATIVE CONTACTED	.	DATE SUBMITTED
CENTURY LINK	USIC DISPATCH CENTER CO. REPRESENTATIVE CONTACTED	.	DATE SUBMITTED
JOHNSON UTILITIES CO.	JAMIE FENDLEY CO. REPRESENTATIVE CONTACTED	.	DATE SUBMITTED
MCI - (VERISON BUISNESS)	SUPERVISOR ON DUTY CO. REPRESENTATIVE CONTACTED	.	DATE SUBMITTED
MEDICOM - APACHE JUNCTION	RON WARFORD - TECHNICAL OP MGR. CO. REPRESENTATIVE CONTACTED	.	DATE SUBMITTED
PINAL COUNTY DEPT. OF PUBLIC WORKS	SCOTT NODES CO. REPRESENTATIVE CONTACTED	.	DATE SUBMITTED
SALT RIVER PROJECT - PINAL COUNTY	SPP BLUE STAKE CO. REPRESENTATIVE CONTACTED	.	DATE SUBMITTED
TOWN OF QUEEN CREEK UTILITIES DEPARTMENT	FRANK LANG CO. REPRESENTATIVE CONTACTED	.	DATE SUBMITTED

NOTE:

THESE DRAWINGS ARE AN INSTRUMENT OF SERVICE ONLY AND ARE AND SHALL REMAIN THE EXCLUSIVE PROPERTY OF HESS-ROUNTREE, INC. NO REPRODUCTION OR OTHER USE SHALL BE MADE BY ANY PERSON OR FIRM OTHER THAN HESS-ROUNTREE, INC. WITHOUT EXPRESS PERMISSION OF HESS-ROUNTREE, INC. ANY UNAUTHORIZED USE SHALL VOID THE ENGINEER'S SEAL AND SIGNATURE HEREON AND NO PROFESSIONAL RESPONSIBILITY WILL REMAIN.

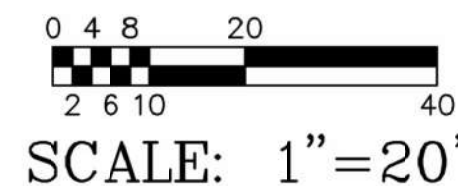
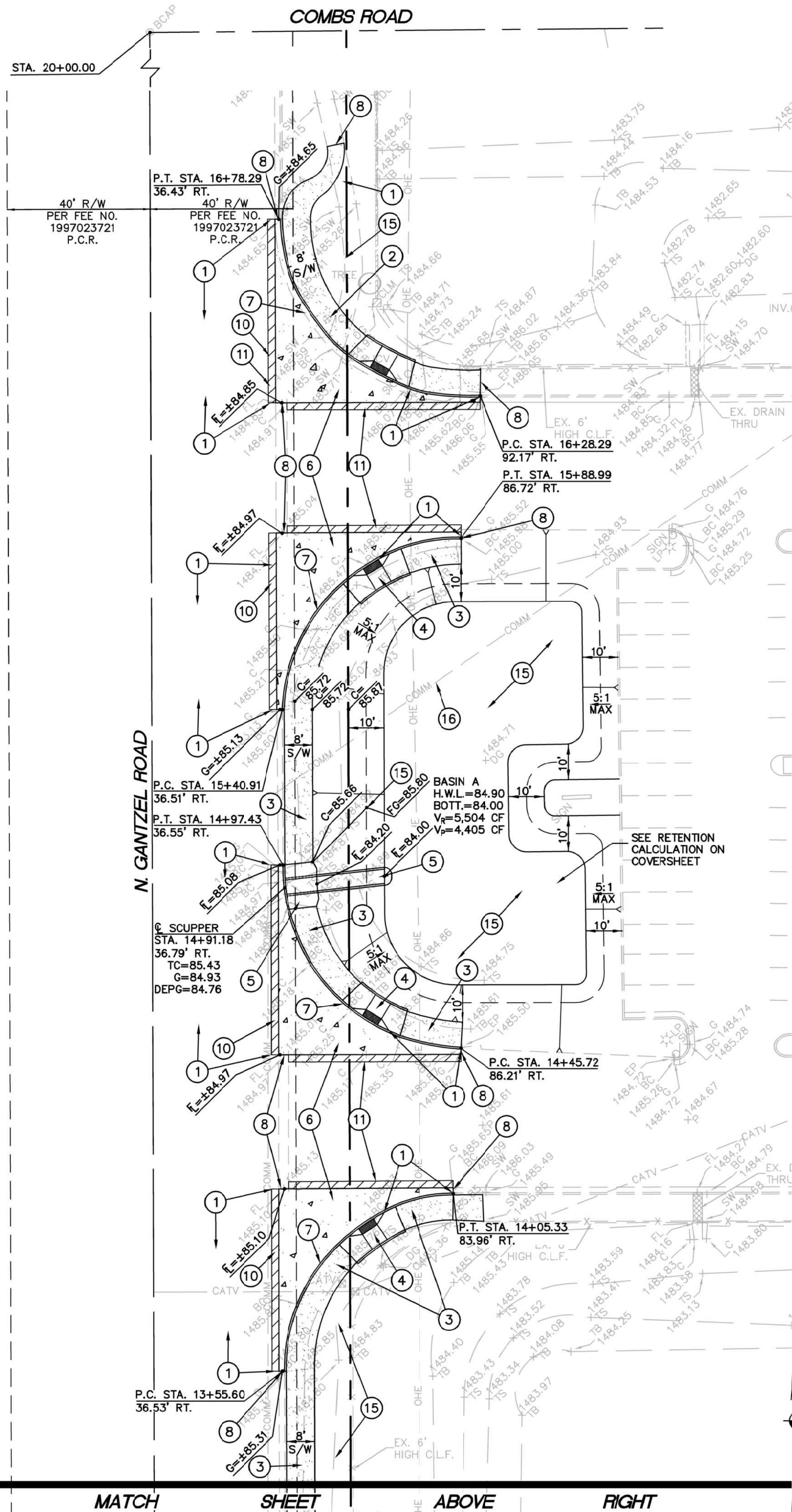

MATCH SHEET BELOW LEFT

MATCH SHEET ABOVE RIGHT

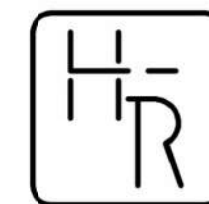
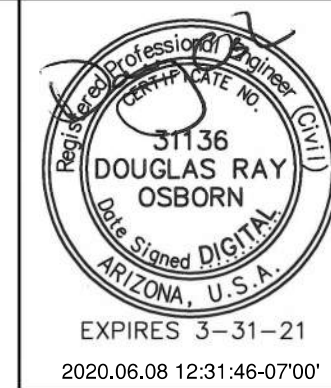

HESS - ROUNTREE, INC.
CONSULTING ENGINEERS & LAND SURVEYORS
9831 SOUTH 51ST STREET, SUITE C110
PHOENIX, ARIZONA 85044 (480)496-0244

DES. **DRO** DRN. **ANM** CKD **DRO** JOB NO. **2003-02**

LEGEND:

- EXISTING BACK OF CURB ELEVATION
- EXISTING GUTTER ELEVATION
- EXISTING EDGE OF PAVEMENT ELEVATION
- EXISTING SIDEWALK ELEVATION
- EXISTING CONCRETE ELEVATION
- EXISTING LANDSCAPE CURB ELEVATION
- EXISTING TOP OF BERM ELEVATION
- EXISTING TOE OF SLOPE ELEVATION
- EXISTING GROUND ELEVATION
- EXISTING DECOMPOSED GRANITE ELEVATION
- EXISTING FLOWLINE ELEVATION
- EXISTING WOOD CHIP ELEVATION
- EXISTING FINISH FLOOR ELEVATION
- EXISTING SIGN
- EXISTING AIR CONDITIONING UNIT
- EXISTING ELECTRIC TRANSFORMER
- EXISTING CABLE TELEVISION BOX
- EXISTING ELECTRIC CABINET
- EXISTING ELECTRIC BOX
- EXISTING LIGHT POLE
- EXISTING SANITARY SEWER CLEANOUT
- EXISTING WATER METER BOX
- EXISTING DOUBLE CHECK VALVE W/SIZE
- EXISTING BACKFLOW PREVENTER W/SIZE
- EXISTING POST
- EXISTING HOSE BIBB
- EXISTING ROOF DRAIN
- EXISTING GAS VALVE
- EXISTING 1" PIPE
- EXISTING FIRE HYDRANT
- EXISTING WATER VALVE
- EXISTING BASKETBALL GOAL
- EXISTING FIRE DEPARTMENT CONNECTION
- EXISTING ELECTRIC OUTLET
- EXISTING POWER POLE
- EXISTING COMMUNICATION BOX
- EXISTING IRRIGATION CONTROL VALVE
- EXISTING PIPE BOLLARD
- EXISTING COLUMN
- EXISTING ELECTRIC BREAKER BOX
- EXISTING ELECTRIC RISER W/SIZE
- EXISTING ELECTRIC METER
- EXISTING WATER RISER
- EXISTING RISER PIPE W/SIZE
- EXISTING BRASS CAP
- EXISTING AREA DRAIN W/RIM ELEVATION
- EXISTING GREASE INTERCEPTOR W/RIM ELEVATION
- EXISTING SANITARY SEWER MANHOLE W/RIM ELEVATION
- EXISTING MANHOLE (TYPE UNKNOWN)
- EXISTING PALM TREE
- EXISTING TREE

OFFSITE CONSTRUCTION NOTES:

- SAWCUT AND REMOVE EXISTING (CONCRETE SIDEWALK, CONCRETE VERTICAL CURB, GUTTER AND APRON AS REQUIRED FOR NEW CONSTRUCTION.
- RECONFIGURE EXISTING IRRIGATION SYSTEM TO RELOCATE IRRIGATION CONTROL VALVE OUT OF NEW SIDEWALK.
- CONSTRUCT CONCRETE SIDEWALK (MAG STANDARD DETAIL NO. 230).
- CONSTRUCT CONCRETE CURB RAMP (MAG STANDARD DETAIL NO. 236-4).
- CONSTRUCT 4-FOOT WIDE CONCRETE SCUPPER WITH SAFETY RAIL (MAG STANDARD DETAIL NO. S 206-1, -2, AND -3). EXTEND SPILLWAY TO 2-FEET BEYOND BASIN BOTTOM.
- CONSTRUCT CONCRETE VALLEY GUTTER APRON (MAG STANDARD DETAIL NO. 240, MODIFIED TO BE 3-FEET WIDE).
- CONSTRUCT CONCRETE VERTICAL CURB AND GUTTER (MAG STANDARD DETAIL NO. 220-1, TYPE A).
- MATCH EXISTING ELEVATION AND LOCATION.
- SAWCUT, REMOVE AND REPLACE 2-FEET OF EXISTING ARTERIAL ROAD A.C. PAVEMENT (6" A.C. OVER 10" A.B.C. OVER COMPACTED SUBGRADE), PER COUNTY REQUIREMENTS.
- SAWCUT, REMOVE AND REPLACE 2-FEET OF EXISTING, PRIVATE DRIVEWAY A.C. PAVEMENT (3" A.C. OVER 8" A.B.C. OVER COMPACTED SUBGRADE, OR MATCH EXISTING WHICHEVER IS GREATER).
- INSTALL A.C. PAVEMENT (3" A.C. (TYPE C-3/4") OVER 8" A.B.C. OVER 10" COMPACTED SUBGRADE).
- INSTALL 6-FOOT HIGH CHAIN LINK FENCE.
- INSTALL 30-FOOT WIDE BY 6-FOOT HIGH DOUBLE SWING GATE.
- REMOVE EXISTING CHAIN LINK FENCE, AND GATE AND FOOTINGS.
- INSTALL NEW 2" THICKNESS OF DECOMPOSED GRANITE. COLOR AND SIZE TO MATCH EXISTING.
- POTHOLE AND FIELD VERIFY ELEVATION AND LOCATIONS PRIOR TO CONSTRUCTION.

- W(BS)— EXISTING WATER LINE (BLUESTAKE)
- G(BS)— EXISTING GAS LINE (BLUESTAKE)
- E(BS)— EXISTING ELECTRIC LINE (BLUESTAKE)
- COMM— EXISTING COMMUNICATION LINE
- OHE— EXISTING OVER HEAD ELECTRIC
- CATV— EXISTING CABLE TELEVISION LINE

- C=85.66** PROPOSED CONCRETE ELEVATION
- FG=85.80** PROPOSED FINISH GRADE ELEVATION
- F=84.20** PROPOSED FLOWLINE ELEVATION
- TC=85.43** PROPOSED TOP OF CURB ELEVATION
- G=84.93** PROPOSED GUTTER ELEVATION
- DEPG=84.76** PROPOSED DEEP GUTTER ELEVATION
- P=85.00** PROPOSED PAVEMENT ELEVATION
- EP=84.55** PROPOSED EDGE OF PAVEMENT ELEVATION
- G.B.** PROPOSED GRADE BREAK

- PROPOSED SIDEWALK
- PROPOSED A.C. PAVEMENT (3" A.C. (TYPE C-3/4") OVER 8" A.B.C. OVER 10" COMPACTED SUBGRADE).
- PROPOSED VALLEY GUTTER APRON MAG STANDARD DETAIL NO. 240

OFFSITE IMPROVEMENT PLAN

J.O. COMBS UNIFIED SCHOOL DISTRICT

IMPROVEMENT PLANS FOR
COMBS TRADITIONAL ACADEMY

DRAWING STATUS	SHEET	OF	
CONSTRUCTION			
DOCUMENTS			
DATE: 06-05-20	2	2	OP-2

